

Durham Spatial Data Explorer Print Layout

- Boundary
- Tax Parcels
- Economic Development
- Infrastructure
- Physical



One Inch = 218 Feet
 Feet 100 200 300

Locator Map

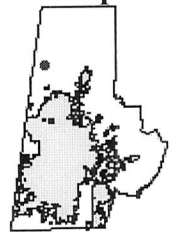

Maps and other data in Spatial Data Explorer were developed from public records and data sources including recorded deeds, plats, and other public records. Users of this map are hereby notified that the aforementioned public primary information sources should be consulted for verification of the information contained on this website. While efforts have been made to use the most current and accurate data, Durham County, The City of Durham, NC and the mapping and software companies assume no legal responsibility for the information contained in Spatial Data Explorer. Parcel Attribute

- Parcel No. (PIN): 0817-04-50-7362
- Parcel-ID (6-Digit): 189202
- Tax Map No. (Obsolete): 888-01-004C-
- Polygon Acreage: 5.00
- Front Dimension: 0
- Total Acreage: 5.00
- Land Use Code: 400
- Land Use Description: *COMMERCIAL*
- District Code: 12
- Subdivision: N/A - NO SUBDIVISION

- Land Value: \$38,900.00
- Building Value: \$127,855.00
- Total Value: \$166,755.00
- Deed Book / Page: 403 / 376
- Plat Book / Page: 403 / 376
- Owner Name: DURHAM KENNEL CLUB INC
EMILIE BE GLANE
- Owner Address: 8318 S LOWELL RD BAHAMA NC 27503
- Property Address: 7318 GUESS RD

INSTRUCTIONS:

Select the items you want to see on your print layout. Position items by dragging. Remove instructions before printing.

- Main Map
- Title
- Small Map
- Legend
- ScaleBar

Scale is APPROXIMATE. Scaled to REGULAR map only.

- Parcel Data

Map Size:

- Large
- Regular

[Remove Instructions](#)



Return to Durham County Tax Administrator's Homepage

Selected Parcel Data

tax bill search
parcel data search

Real Property Effective Date: January 1, 2006
 Displayed Data Current as of: 1/30/2006

Owner Name	DURHAM KENNEL CLUB INC EMILIE BE GLANE		
Owner ID/ Account Number/ Account Number	2021350		
Parcel Ref. Number	189202		
OLD Parcel Ref. Number	888 -01-004C-		
Tax Year	2006		
Physical Address	7318 GUESS RD		
PIN	Map	SubMap	Block Parcel SubParcel Display GIS Parcel Data
	0817	04	50 7362
Legal Description 1	NE/S GUESS RD #		
Legal Description 2	2 THOMAS F		
Deed Book	403		
Deed Page	376		
Plat Book	403		
Plat Page	376		
Account Number	2021350 << Select for Name and Address		
Tax District	12		
District Description	CNTY-DRHM/FD-LEBANON		
Fair market Value	\$166,755.00		
Deferred Value	\$0.00		
Appraised Value	\$166,755.00		
Assessed Value	\$166,755.00		
Exempt Value	\$0.00		
Taxable Value	\$166,755.00		
Actual/Effective Year Built	0		
Number of Bedrooms	0		
Number of Bathrooms	0.0		
Total Number of Rooms	0		
Finished Area	6,625		

TOP OF PAGE

Last updated: February 28, 2005

© 2006, Durham County Government, North Carolina. All rights reserved.
 200 E Main Street, Durham, NC 27701
webmaster@durhamcountync.gov
[Website Disclaimer & Policies](#)



Return to Durham County Tax Administrator's Homepage

View Selected Tax Bill Data

Displayed Data Current as of: 1/30/2006

Owner ID/ Account Number

2021350

Owner Name & Address

DURHAM KENNEL CLUB INC EMILIE BE GLANE
 8318 S LOWELL RD
 BAHAMA, NC 27503

Tax Year	Receipt Number	Rate Year	Parcel Ref. Number	Date Due	Date Last Paid	Total Owed	Collected Amount	Amount Due	Tax District	Taxable Value
2005	4508745	2005	189202	01/05/2006	09/19/2005	\$1,474.12	\$1,474.12	\$0.00	12	\$166,755.00
2004	4162420	2004	189202	01/05/2005	12/08/2004	\$1,429.09	\$1,429.09	\$0.00	12	\$166,755.00

TOP OF PAGE

Last updated: February 28, 2005

© 2006, Durham County Government, North Carolina. All rights reserved.
 200 E Main Street, Durham, NC 27701
webmaster@durhamcountync.gov
[Website Disclaimer & Policies](#)

Return →

BOOK 2582 PAGE 224

PIEDMONT ELECTRIC MEMBERSHIP CORPORATION
P.O. DRAWER 1179 HILLSBOROUGH NORTH CAROLINA 27278

State of North Carolina
County of Durham

Prepared By: Bill Smith
Job Name: Durham Kennel Club, Inc.
Job No.: 10-0702-

This indenture, made and entered into this 20 day of Aug, 1998, by and
Between Durham Kennel Club Inc. Sharon K Pitz - President
Marjorie J White - Sec

Hereinafter called Grantor (whether one or more), and PIEDMONT ELECTRIC MEMBERSHIP CORPORATION, hereinafter called Grantee:

WITNESSETH: That Grantor, for a good and valuable consideration, the receipt of which is hereby acknowledged, does grant and convey unto Grantee, its successors and assigns the perpetual right to enter upon lands of Grantor and erect, construct, reconstruct, replace, maintain and use poles, wires, lines, cables, and all necessary and proper foundations, footings, crossarms and other appliances and fixtures for the purposes of transmitting and/or distributing electric power and for Grantee's communication purposes, and the right to cut, trim or control the growth of trees, shrubbery and other obstacles which may be deemed by Grantee to be an interference or danger to the operation and maintenance of said line or system or which may be judged by the Grantee to impair public safety by virtue of its proximity to said line or system: (said rights and controls to apply to an area within 6 feet on each side of the center of said right of way), and to license, permit, or otherwise agree to the joint use or occupancy of the line or system by any other person, association or corporation for electrification or telephone purposes, with the understanding that all facilities installed on Grantor's land at Grantee's expense, shall remain the property of Grantee, removal at the option of Grantee. The land of the Grantor over which said rights and easements are granted is a part of the property described as follows: Durham Kennel Club Inc. owns acres on Guess Ro. Easement to set (1) Pole for security light.

Lebanon Township, Durham County, State of North Carolina.
The undersigned covenant that they are the owners of the above described lands and that the said lands are free and clear of encumbrances and liens of whatsoever character, with the right to convey the said rights and easements and will warrant and defend the title to these rights against the lawful claims of all persons whomsoever.

In witness whereof, this instrument is executed on the date first above written, signed, sealed, and delivered in the presence of:

Marjorie J. White Sec WITNESS Sharon K Pitz President DKS
WITNESS Seal Seal Seal

State of North Carolina Orange County
I, Nita J Stollard, a notary public for said county and state, do hereby certify that Marjorie J White personally appeared before me this day and acknowledged that she is secretary of Durham Kennel Club Inc. a corporation, and that by authority duly given and as the act of said corporation the foregoing and annexed instrument was signed in its name by Sharon K Pitz its President, sealed with its corporate seal and attested by himself as its secretary.
Witness my hand and official seal, this the 20 day of Aug, 1998
My commission expires: 7-7-2001 Notary Public Nita J Stollard

State of North Carolina - Durham County
The foregoing certificate(s) of Nita J Stollard

A Notary (Notaries) Public of the designated Governmental units is (are) certified to be correct BOOK 2582 PAGE 224

This 6 day of Jan, 1999 '99 JAN 6 AM 8 46

WILLIE L. COVINGTON 00335 By: Carol J Jenkins WILLIE L. COVINGTON
Register of Deeds Assistant / Deputy Register of Deeds REGISTER OF DEEDS
DURHAM COUNTY, N.C. 800

ENCLOSURE PP 17-21
PROP. OF THOMAS F. PERE

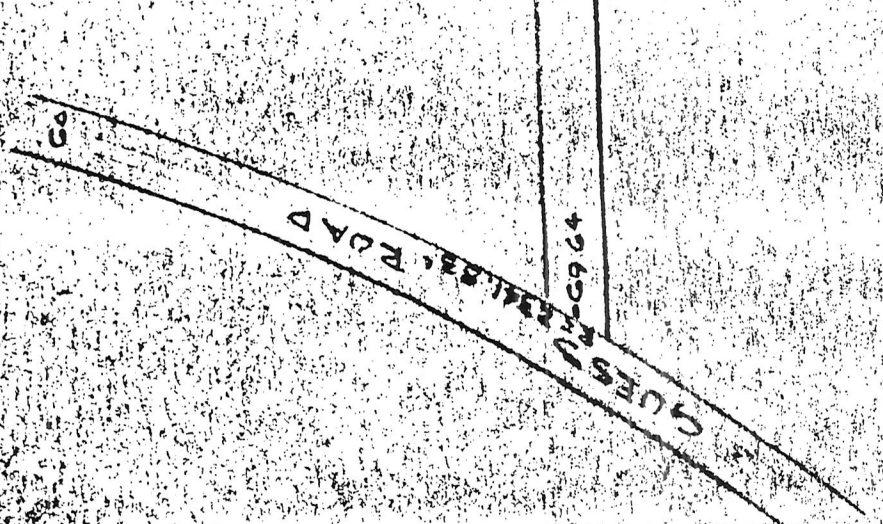

I & W. H. S. & Co. Surveyors
 This is to certify that the surveyed line
 shown on this plan; that the property lines
 structures are accurately shown thereon;
 structures located on this property encroach;
 adjacent street or property; and that no stru-
 adjacent property encroaches on the front
 wayed.

This is to certify that the surveyed line
 shown on this plan; that the property lines
 structures are accurately shown thereon;
 structures located on this property encroach;
 adjacent street or property; and that no stru-
 adjacent property encroaches on the front
 wayed.